

GILBERT HOUSE



**CHURCHILL GARDENS
LONDON SW1V 3HN**

£2080pcm (£480pw)

Newly refurbished to an exceptional standard, this spacious two bedroom flat is located on the fifth floor of a popular purpose built Grade II listed block with lift access. The accommodation is well proportioned with two good sized double bedrooms, both with built-in storage, served by a separate bathroom, bright reception room with access to a balcony offering views over the River Thames and the iconic Battersea Power Station.

The property also benefits from a well designed and functional kitchen that boasts all the essential appliances of a home and is furthermore finished to a very high standard.

Students Considered.
Sorry No DSS or Pets.
Deposit £2475.

GILBERT HOUSE



PROPERTY FEATURES

- Newly Refurbished
- Private Balcony
- Central Location
- Modern Kitchen
- Communal Garden
- Shops and amenities nearby
- Views Over the River
- Heating and Hot Water Included
- Two Double Bedrooms
- Plenty of Built in Storage



PROPERTY INFO

- Available 1st August 2015
- Fully furnished

Students Considered.
Sorry No DSS or Pets.
Deposit £2475.

GILBERT HOUSE



Students Considered.
Sorry No DSS or Pets.
Deposit £2475.

Gilbert House

Approximate Internal Floor Area
689 sq ft / 64 sq m

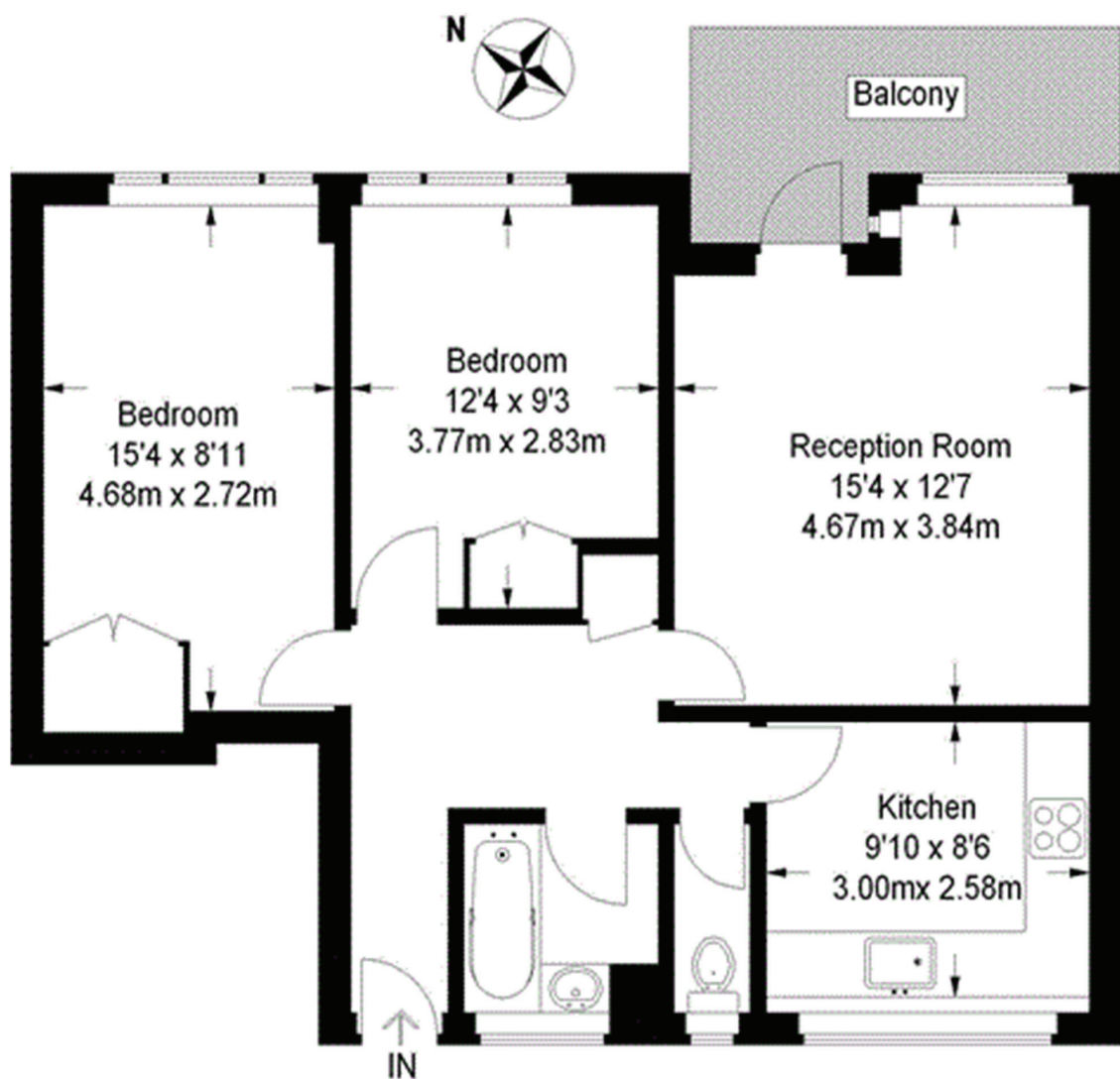

Fifth Floor

For illustrative purposes only. Not to scale.

GILBERT HOUSE

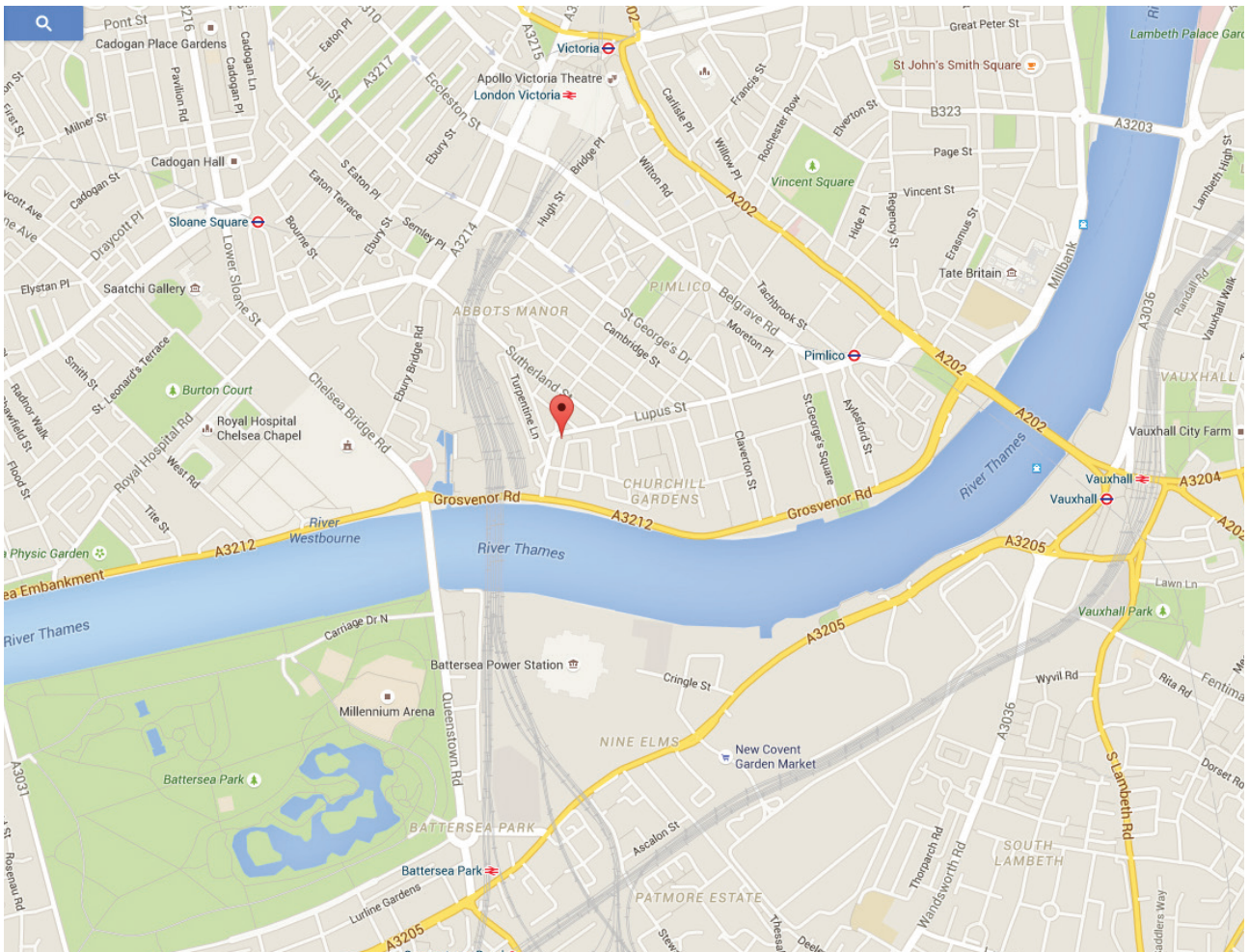

Students Considered.
Sorry No DSS or Pets.
Deposit £2475.